

 **optimize**technologies

Introducing **EXP™**

the new gold standard of
extreme pressure chromatography
hardware and consumables.

UHPPLC

www.optimize-tech.com/exp





extreme pressure

Welcome to the new gold standard of ultra high pressure liquid chromatography (UHPLC) hardware and consumables. Optimize Technologies' EXP product family includes fittings, filters, and packed-bed products which offer unparalleled convenience and ease of use through exciting new patented and patent-pending innovations. This advanced system is the first design to provide reusable hand-tight connections and hand-tight cartridge replacement for UHPLC. These innovations significantly accelerate challenging UHPLC applications and reduce costly instrument downtime.

Revolutionary features include:

- EXP titanium/PEEK hybrid ferrule offering repeated zero-dead-volume connections, hand-tight to 8,700 psi or wrench-tight to 20,000 psi.
- EXP holders and cartridges with ultra-low internal swept volume and hand-tight cartridge changeover for use to 20,000 psi.

This rare combination of attributes enables our EXP components to provide excellent protection with negligible impact on analyte retention and peak shape. The elegant design of our EXP line showcases sleek architecture for easy installation in crowded instrument compartments without compromising accessibility. Our commitment to exceed industry standards yields an entire EXP product family conservatively rated to 20,000 psi. The EXP product line, as well as virtually all Optimize products, are proudly designed and manufactured in our facility in Oregon, USA*.

From the name you've trusted for 25 years of precision innovation in HPLC accessories and consumables, EXP represents the culmination of a generation of research and development in our field. And though our exacting quality control consistently guarantees that every product bearing the EXP trademark exemplifies our high standards, our responsive customer service and expert technical support are always here to back you up.

* 100% of all Optimize **EXP** products are made in the U.S.A. from raw materials originating in the U.S.A.
98% of all Optimize products are made in the U.S.A. from raw materials originating in the U.S.A.

EXPTM

table of contents

EXP **fittings**

Titanium Hybrid Ferrule 1

Hand-Tight 3

Hex Head 3

EXP **filtration**

Stem Filter 5

Pre-Column Filter 7

EXP **multi-purpose packed beds**

Stem Trap 9

Trap 11

Guard Column 13

EXP **information**

Trademarks and Patents 15

Contact Information 16

The Foundation of the EXP Family

Optimize Technologies recognizes the challenges faced by scientists and technicians in the constantly evolving field of chromatography and LC instrumentation. Ultra high pressure liquid chromatography is one good example of how these advances present an opportunity for innovative products.

In response to evolving UHPLC technologies, Optimize delivers with the EXP Titanium PEEK Hybrid ferrule. The ingenuity of the EXP ferrule lies in a design which adjusts to any 10-32 port depth and can subsequently be removed and reused in a different port while still maintaining adjustability. The EXP ferrule provides the necessary zero-dead-volume seal to allow connections beyond 20,000 psi.

The EXP ferrule, with its innovative capabilities, forms the foundation of our EXP product family. A quick look through these pages shows that the EXP ferrule is incorporated into the entire EXP product line, demonstrating its wide array of applications. If you are interested to see how the EXP products can work for you, please contact Optimize Technologies or one of our representatives. At Optimize, we strive to develop new products that are straight forward, yet elegant, solutions to daily issues in the lab.

ADVANTAGES OF THE EXP FERRULE

- Rated to 20,000+ psi
- Tested to 30,000 psi
- Auto-adjusting ZDV connection
- Intended for many repeat uses



actual size

UHPLC

A Perfect Seal

with every connection

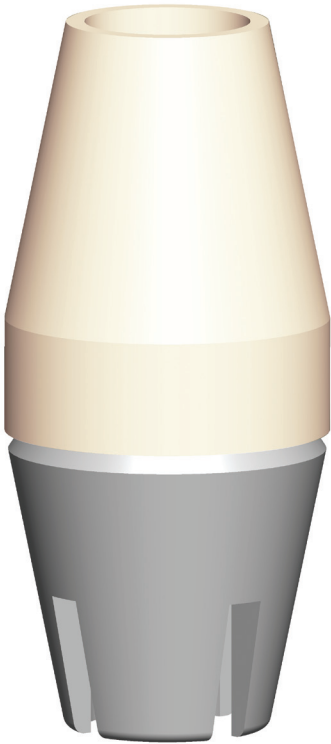

PEEK:

Proven sealing ability
beyond 20,000 psi.

Titanium:

Enables the swage to
be released and reset.
Intended for many
repeat connections.

Patent Pending



EXP FITTING SYSTEM

The EXP Fitting System is the premier adjustable nut and ferrule compression fitting for extreme high-pressure connections between 1/16" tubing and any 10-32 port. The key advantages of the EXP fitting lie at the confluence of simplicity and versatility.

The patent-pending Titanium Hybrid Ferrule integrates the resilience of titanium with the proven sealing ability of PEEK in a superb one-piece design. The Hybrid Ferrule provides a perfect seal with every connection, yet the swage can be released without tools to adjust to the different port depths of various hardware. This adjustability provides unlimited value through repeated zero-dead-volume connections with any 10-32 port configuration.

With the EXP Fitting System, you no longer have to clip off and replace swaged ferrules or wonder if you are achieving the best possible connection.

ADVANTAGES OF EXP FITTINGS

- Available in hand-tight & wrench-tight configurations
- Rated to 20,000+ psi
- Tested to 30,000 psi
- Auto-adjusting ZDV connection
- Intended for many repeat uses

Guaranteed
you will love them as much as we do.

UHPPLC

HAND-TIGHT

hand-Tight to 8,700+ psi
wrench-Tight to 20,000+ psi

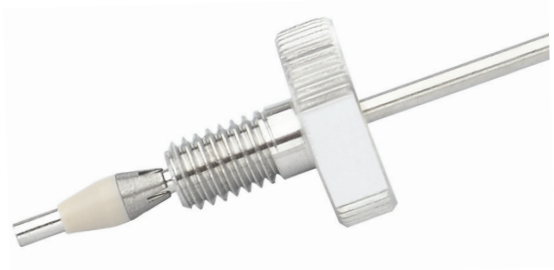

HEX HEAD

rated to 20,000+ psi



EXP TITANIUM HYBRID FERRULES

15-24-03831	Titanium Hybrid Ferrule
15-24-03832	Titanium Hybrid Ferrules (10/pk)

HAND-TIGHT EXP FITTINGS

15-20-03888	10-32 Hand-Tight Nut & Titanium Ferrule
15-20-03930	10-32 Hand-Tight Nut & Titanium Ferrule (10/pk)

HEX HEAD EXP FITTINGS

15-20-04120	10-32 Standard Hex Head Nut & Titanium Hybrid Ferrule
15-20-03839	10-32 Hex Head Nut, Short
15-20-03840	10-32 Short Hex Head Nuts & Titanium Hybrid Ferrules (10/pk)
15-20-03833	10-32 Hex Head Nut, Standard
15-20-03834	10-32 Standard Hex Head Nuts & Titanium Hybrid Ferrules (10/pk)
15-20-03841	10-32 Hex Head Nut, Long
15-20-03842	10-32 Long Hex Head Nuts & Titanium Hybrid Ferrules (10/pk)

Patent Pending

EXP STEM FILTER

Modern UHPLC and UHPLC/MS instrumentation pushes the envelope in fluid-handling with tiny passages and extremely high pressures. At any time, an unprotected system is virtually a stray 1um seal fragment away from failure, loss of priceless data continuity, and subsequent troubleshooting and repair. The best assurance against this costly prospect comes from safeguarding your system with thorough filtration.

The EXP Stem Filter features a choice of frit porosities integrated with our patented auto-adjusting stem for repeated ZDV connections with any 10-32 port. The entire filter stem and reusable holder are only slightly larger than a standard HPLC fitting. This slim architecture allows it to easily fit into crowded instrument compartments, tightly spaced injection ports, and anywhere else you need an extra level of protection against clogging and contamination. The EXP Stem Filter is an ideal solution to protect expensive UHPLC columns, injectors, autosamplers, and MS electrospray tips without extra-column effects.

When tightened by hand, the EXP Stem Filter seals to 8,700+ psi. The reusable holder hardware also incorporates wrench flats to enable flawless sealing to 20,000+ psi (1,400 bar). The EXP Stem Filter is the ultimate low-impact protection for your expensive UHPLC and MS equipment, assuring trouble-free performance so you can concentrate on the data, not troubleshooting.

ADVANTAGES OF EXP STEM FILTERS

- Approved for use at 20,000 psi
- Hand-tight and wrench-tight configuration
- Reusable holder intended for many repeat uses
- Auto-adjusting ZDV connection
- Low-dispersion cartridges
- Custom volumes/porosities available
- Ultra-low .27 μ L total swept volume

UHPLC

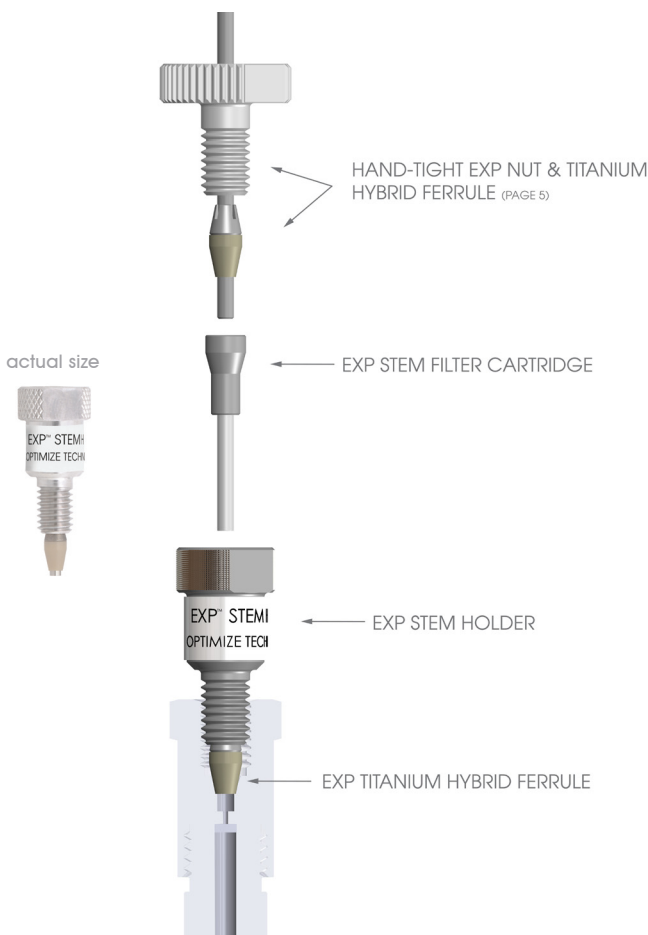

EXP STEM FILTER KIT

15-04-04122 0.2 μm , **EXP** Stem Filter Kit

15-04-04123 0.5 μm , **EXP** Stem Filter Kit

Kit includes: Holder, Ferrule & 3 Stem Filter Cartridges.

EXP STEM FILTER REPLACEMENT CARTRIDGES

15-04-04117 0.2 μm , **EXP** Stem Filter Cartridge, 5/Pk

15-04-04119 0.5 μm , **EXP** Stem Filter Cartridge, 5/Pk

EXP OPTIONAL CONNECT FITTINGS

15-20-03888 10-32 Hand-Tight Nut & Titanium Ferrule (recommended)

15-20-04120 10-32 Standard Hex Head Nut & Titanium Hybrid Ferrule

U.S. Pat. No.s 5,525,303; 5,730,943; 5,911,954 and other U.S. and foreign patents pending.

EXP PRE-COLUMN FILTER

The EXP Pre-Column Hand-Tight Filter is ideal for protecting small particle size UHPLC columns. Such techniques analyze samples in the most demanding applications, which can decrease the life of these expensive columns. EXP Pre-Column Filters help extend that life and protect your column investment without sacrificing performance. Free-turn® architecture allows the user to **change cartridges by hand** without breaking fluid connections on the holder inlet/outlet.

EXP Pre-Column Filter holders are available with Titanium Hybrid ferrules for easy direct connection to any 10-32 port. The filter holder comes as a complete package including fittings to provide repeated zero-dead-volume column connections.

ADVANTAGES OF EXP PRE-COLUMN FILTERS

- Approved for use at 20,000 psi
- Tested to 30,000 psi
- Depth filtration maximizes capacity
- Auto-adjusting ZDV column connection
- Custom volumes/porosities available
- Hand-tight filter replacement - NO TOOLS!
- Low-volume, low-dispersion cartridges
- Hardened stainless steel end cap eliminates galling

simple.
innovative.
easy to use.

UHPLC

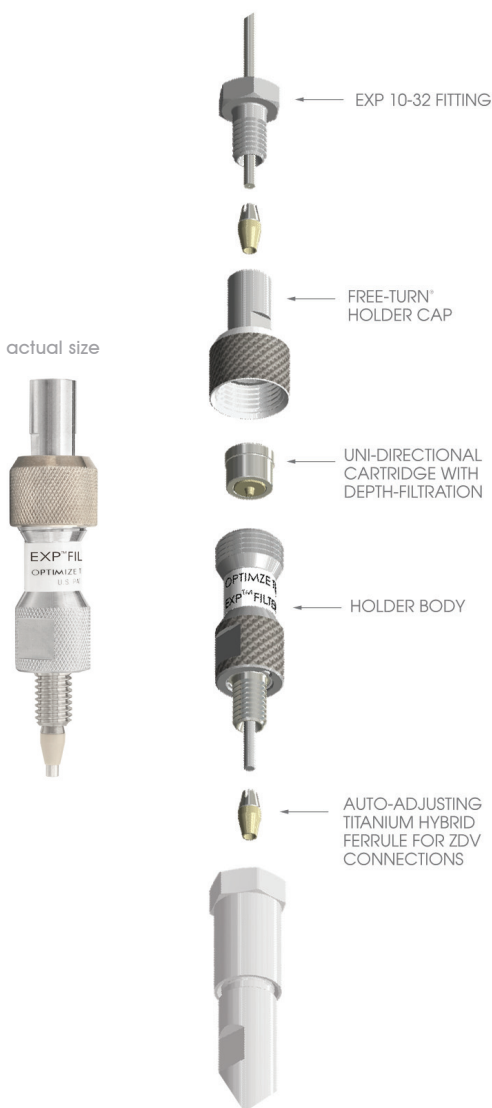

EXP PRE-COLUMN FILTER HOLDER

15-04-03837

EXP Pre-Column Filter Holder
(fittings included)



EXP PRE-COLUMN REPLACEMENT FILTER CARTRIDGES

15-04-03093

0.5 μm , **EXP** Filter Cartridge, 5/Pk

15-04-03096

0.2 μm , **EXP** Filter Cartridge, 5/Pk

15-04-03094

0.5 μm , **EXP** Filter Cartridge, 10/Pk

15-04-03097

0.2 μm , **EXP** Filter Cartridge, 10/Pk

U.S. Pat. No.s 5,525,303; 5,730,943; 5,911,954
and other U.S. and foreign patents pending.

STEM TRAPS WITH HALO[®]

The entire EXP Stem Trap and reusable holder are only slightly larger than a standard HPLC fitting. Its slim architecture allows it to easily fit into crowded instrument compartments or to connect directly to tightly-spaced injection ports. When tightened by hand, the EXP Stem Trap seals to 8,700+ psi. All configurations incorporate wrench-flats to enable **flawless sealing to 20,000 psi (1,400 bar)**. The unique packed floating stem installs directly into any 10-32 port and automatically adjusts to provide a perfect ZDV connection.

Our specialized features, patented technology, precision engineering and state-of-the-art manufacturing make the new EXP Stem Trap an unbeatable choice for Ultra High Pressure trapping applications.

ADVANTAGES OF EXP STEM TRAPS

- Hand-tight and wrench-tight configurations
- Intended for many repeat uses
- Auto-adjusting ZDV connection
- Rated to 20,000 psi
- Many chemistries available including custom packing
- Available in bed volumes from 0.17ul to 2.6ul

**Unparalleled
convenience
& efficiency**

UHPHPLC



EXP Stem Trap Kit



Please use the table below to find the bed volume and phase you require. **Example:** a three pack of 0.17 μ L Stem Traps with C8 phase would have part number 15-03997-HB.

EXP STEM TRAP KIT SELECTION GUIDE

	Bed Volume	Suggested Max Load Rate*	Dimension Code	Phase Code	Phase
HOLDER & 3 PACK OF STEMS	0.17 μ L	60 μ L/min	0 3 9 9 7	H A	C18
	0.33 μ L	120 μ L/min	0 4 0 0 3	H B	C8
	0.68 μ L	250 μ L/min	0 4 0 0 9	H D	HILIC
	1.5 μ L	500 μ L/min	0 4 0 1 5	H E	RP-AMIDE
	2.6 μ L	1 mL/min	0 4 0 2 1	H F	PHENYL-HEXL
				E S	CUSTOM



Custom packing is also available. Please contact us if you do not see the materials you require.

Replacement Stem Traps and Stem Holders are also available separately.

* Suggested max load rate is based on 60/40 Acetonitrile/Water Mobile phase

TRAP COLUMNS WITH HALO[®]

The patent-pending Hand-Tight EXP Trap Column is rated for use up to 20,000 psi (1,400 bar). This unique design connects directly to any injection valve (with 10-32 threads) or in-line with 1/16" stainless tubing for unparalleled convenience and efficiency.

The EXP Cartridge System enables chemists to quickly remove detergents or salts which can affect the ionization process in MS work. This trapping technique can concentrate the sample directly on-line thus allowing for increased recovery of precious sample material compared to off-line techniques. On-line trapping readily lends itself to automation for high-throughput analysis in UHPLC/MS applications. Free-turn architecture allows the user to **change cartridges by hand** without breaking fluid connections on the holder inlet/outlet.

Our specialized features, patented technology, precision engineering and state-of-the-art manufacturing make the new EXP Trap Column an unbeatable choice for Ultra High Pressure trapping applications.

ADVANTAGES OF EXP TRAP COLUMNS

- Hand-tight to 20,000 psi (1400 bar)
- Tested to 30,000 psi
- Uni-directional cartridge
- Auto-adjusting ZDV connections
- Many phases available including custom packing
- Available in bed volumes from 4ul to 100ul
- Hardened stainless steel end cap eliminates galling

UHPLC

EXP Direct Connect Holder



actual size

EXP In-Line Holder



EXP HOLDERS

15-02-03956

EXP Direct Connect Holder
(fittings included)

15-02-03946

EXP In-Line Holder
(fittings included)

Please use the table below to find the bed volume and phase you require. **Example:** a three pack of 4 μ L Cartridges with C8 Phase would have part number 15-03964-HB.

EXP TRAP CARTRIDGE SELECTION GUIDE

Bed Volume	Suggested Max Load Rate*	Dimension	Dimension Code	Phase Code	Phase	
3 PACKS	4 μ L	2 mL/min	0 3 9 6 4	H A	C18	
	10 μ L	4 mL/min	0 3 9 6 9	H B	C8	
	20 μ L	6 mL/min	0 3 9 7 3	H D	HILIC	
	40 μ L	8 mL/min	0 3 9 7 8	H E	RP-AMIDE	
	100 μ L	10 mL/min	4.6 x 5 mm	0 3 9 8 3	H F	PHENYL-HEXL
					E S	CUSTOM



Part Number

Custom packing is also available. Please contact us if you do not see the materials you require.

*Suggested max load rate is based on 60/40 Acetonitrile/Water mobile phase
U.S. Pat. No.s 5,525,303; 5,730,943; 5,911,954
and other U.S. and foreign patents pending.

GUARD COLUMNS

The EXP Guard Column cartridge system is rated to 15,000 psi with hand-tight replaceable cartridges. This unique design connects directly to any UHPLC column with the auto-adjusting Titanium Hybrid ferrule and EXP[™] Fittings, providing repeated zero-dead-volume connections and easy adjustability between various column types.

Free-turn[®] architecture allows the user to **change cartridges by hand** without breaking fluid connections on the holder inlet/outlet. The combination of low-dispersion and ultra high-pressure capabilities provides effective protection with negligible effects on retention time, plate count, and peak shape.

ADVANTAGES OF EXP GUARD COLUMNS

- Hand-tight guard replacement - NO TOOLS!
- Hardware rated to 20,000 psi
- Packed guard rated to **15,000 psi (1,000 bar)** for routine use
- 1.4 μ l Swept Volume (excluding packed bed)
- Hardened stainless steel end cap eliminates galling
- Low-volume, low-dispersion cartridges
- Auto-adjusting ZDV column connection

**Unparalleled
convenience
& efficiency**

UHPLC

optimize trademarks

EXP[™] and the Optimize Technologies Rain Drop Logo are trademarks of Optimize Technologies Inc.

Optimize Technologies[®] and Free-Turn[®] are registered trademarks of Optimize Technologies Inc.

optimize patents

U.S. Pat. No.s 5,525,303; 5,730,943; 5,911,954 and other U.S. and foreign patents pending.

other trademarks

Halo[®] is a registered Trademark of Advanced Materials Technology Inc.

UHP LC

optimize technologies

offering the most innovative laboratory solutions in the world

For more information about Optimize products including pricing and availability, please contact us directly or visit our website to find an Optimize dealer in your area.

To request a catalog with our complete product offerings or to download an electronic copy, visit www.optimize.tech.com/literature.

Your Local Optimize Distributor:



Postboks 88
N-3441 RØYKEN

Telefon : 31 28 47 33
Telefax : 31 28 60 18

Webside: www.w-tverdal.no
Email: wtverdal@w-tverdal.no



optimize technologies

13993 Fir Street
Oregon City, OR 97045

TF: 800.669.9015 | Tel: 503.557.9994 | Fax: 503.557.9995

www.optimize.tech.com